

# TOUCH *basic IL*

Document Rev0

User Manual

LOGIC  
office

---

Cable Handswitch  
for installation  
in the desktop



## Contents

1	Preface.....	3
2	General .....	3
2.1	Intended Use.....	3
2.2	Functionality TOUCHbasic.....	3
2.3	Package Contents .....	4
2.4	Overview .....	4
3	Mounting Instructions.....	5
4	Functions .....	6
5	Appendix .....	6
5.1	Possible faults and remedies .....	6
6	Further Information .....	7
6.1	End of life disposal .....	7
6.2	Technical data.....	7
6.3	Manufacturer .....	7

## 1 Preface

Dear customer,

Thank you for choosing a TOUCHbasic cable handswitch from LOGICDATA Electronic & Software Entwicklungs GmbH. You are now in possession of a state-of-the-art product.

## 2 General

### 2.1 Intended Use

The TOUCHbasic cable handswitch must be used with **LOGICDATA** control units. The control unit must be installed, initially operated and functional tested by qualified personnel only. Use other than described above is only allowed with permission of **LOGICDATA**.



**Note:** for definitions and information concerning **LOGICDATA** control units, please refer to the applicable user manual.

Aside of moving your table up and down your **LOGICDATA** control unit is able to carry out other functions.

### 2.2 Functionality TOUCHbasic

The TOUCHbasic cable handswitch offers the following functionality:

- Simple handswitch to move the desktop position up and down
- Big and comfortable to use buttons
- Compatible to all LOGICDATA motor controls
- No protruding parts
- Easy and fast mounting

## 2.3 Package Contents

The TOUCHbasic cable handswitch package contains:



Figure 1: Package contents

- ① TOUCHbasic-IL cable handswitch



**Danger:** only use original accessories. Parts may only be replaced by qualified service technicians, otherwise the warranty/guarantee shall be null and void.



**Caution:** do not drop the handswitch on the floor! There is a danger of electric shock due to broken housing parts.



**Note:** mounting screws are not within scope of delivery.

## 2.4 Overview

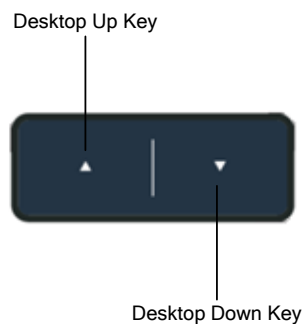

Figure 2: Buttons and Display on TOUCH-Basic-IL-2-LD



**Note:** this document contains illustrations of the user interface design of the LOGICDATA standard handswitch TOUCH-Basic-IL-2-LD. The user interface design can be customized, contact LOGICDATA for further information!

### 3 Mounting Instructions

Mount the TOUCH cable handswitch in an appropriate position.

1. Unpack the handswitch.



**Note:** ensure eco-friendly disposal of the packaging materials (separate the plastic parts and cardboard for collection).

2. Drill/Mill a mounting hole. The hole-pattern is depicted in the datasheet.
3. Insert the desktop-integrated TOUCH cable handswitch into the mounting hole from the top. Mounting is done without any additional screws, the rubber ribs hold the handswitch in place.
4. Connect the handswitch to the control unit using the jack marked with HS.



**Caution:** unplug the power cord of the control unit while mounting the handswitch!

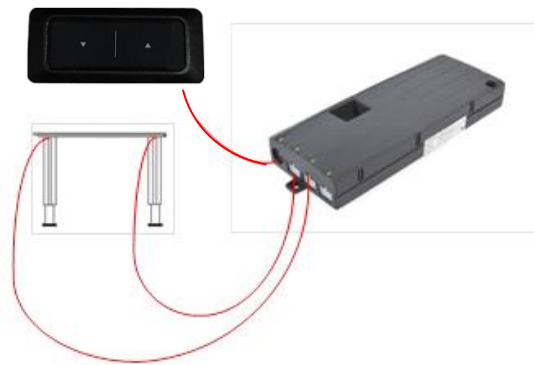

Figure 3: Connection of the TOUCHbasic to a COMPACT<sup>eco</sup> control unit





**Note:** the design of the desktop-integrated TOUCH cable handswitch is symmetric. To prevent that the movement directions are swapped by wrong mounting inside the desktop, a text on the bottom side of the TOUCH indicates the movement direction of both buttons.



Figure 4: The text "UP" and "DOWN" indicate the movement direction of each button to prevent wrong mounting

## 4 Functions

Function	Description	Note
Desk upwards 	For an upward adjustment of the desk push this button.  Push this button until the desired height of the desk has been reached.	The desk will continue driving upwards until you release the button, or the maximum height is reached.
Desk downwards 	For a downward adjustment of the desk push this button.  Push this button until the desired height of the desk has been reached.	The desk will continue driving downwards until you release the button, or the minimum height is reached.

## 5 Appendix

### 5.1 Possible faults and remedies

#### Handswitch does not work

Possible cause	Remedy
Cable is not plugged in	Plug the plug in the intended jack marked with HS
Cable is not plugged in as intended	
Bad pin contact	Plug off the handswitch and plug it in as intended
Cable is defective	Replace the handswitch
Handswitch is defective	Replace the handswitch

## 6 Further Information

### 6.1 End of life disposal

When you no longer require the TOUCHbasic cable handswitch, please note the following for disposal:



**Note:** the TOUCHbasic cable handswitch is electrical or electronic equipment according to directive 2002/96/EC and therefore marked with the symbol depicted on the left.



**Note:** ensure eco-friendly disposal of all the handswitch components (separate the plastic and electronic parts for collection).

Also ensure eco-friendly disposal of all the other components (drives, cables, etc.).



**Note:** this product is RoHS compliant according to directive 2002/95/EC!



**Note:** this product is REACH compliant according to directive 2006/121/EC (Edict 1907/2006)

### 6.2 Technical data



**Note:** you can find the technical data of your handswitch in the appropriate datasheet.

### 6.3 Manufacturer

#### LOGICDATA

Electronic & Software Entwicklungs GmbH  
 Wirtschaftspark 18  
 A-8530 Deutschlandsberg - Austria

Tel.: +43 (0)3462 5198 0  
 Fax: +43 (0)3462 5198 530  
 Email: [office@logicdata.at](mailto:office@logicdata.at)  
 URL: [www.logicdata.at](http://www.logicdata.at)