

DYNAMIC MOTION **system**

# DMUI- **EASY2move**

User Manual





## **DMUI-EASY2move - Operating Manual**

Document Version 1.0 / August 2019

This document was originally published in English.

## **LOGICDATA Electronic & Software Entwicklungs GmbH**

Wirtschaftspark 18

8530 Deutschlandsberg

Austria

Phone: +43 (0) 3462 51 98 0

Fax: +43 (0) 3462 51 98 1030

Internet: <http://www.logicdata.net>

Email: [office.at@logicdata.net](mailto:office.at@logicdata.net)



# CONTENTS

<b>1</b>	<b>General information</b>	<b>5</b>
1.1	Other applicable documents	5
1.2	Copyright	5
1.3	Royalty-free use of images and text	5
1.4	Trademarks	5
<b>2</b>	<b>Safety</b>	<b>6</b>
2.1	Target audience	6
2.2	General safety regulations	6
2.3	Intended use	6
2.4	Reasonably foreseeable misuse	6
2.5	Explanation of symbols and signal words	7
2.6	Liability	7
2.7	Residual risks	8
2.8	Skilled Persons	9
2.9	Notes for Resellers	9
<b>3</b>	<b>Scope of delivery</b>	<b>9</b>
<b>4</b>	<b>Unpackaging</b>	<b>10</b>
<b>5</b>	<b>Products</b>	<b>10</b>
5.1	Key Product Features	10
5.2	Dimensions	11
5.3	Drilling Template	12
<b>6</b>	<b>Assembly</b>	<b>13</b>
6.1	Safety During Assembly	13
6.2.1	Required Components	13
6.2.2	Process	13
6.2.3	Completing Assembly	13
<b>7</b>	<b>Operation</b>	<b>14</b>
7.1	Adjusting the Table Top Height	14
7.1.1	Moving the Table Top Up	14
7.2.2	Moving the Table Top Down	15
7.2	Shelf Stop and Container Stop Positions	15



7.2.1	Saving a Container Stop or Shelf Stop Position	15
7.2.2	Deleting a Container Stop or Shelf Stop Position	16
7.3	Performing a Position Reset Procedure	16
7.4	Factory Reset (So Reset)	16
<b>8</b>	<b>System Information</b>	<b>17</b>
<b>8</b>	<b>Additional Information</b>	<b>18</b>
8.1	Software-Dependent Functions	18
8.2	Disassembly	18
8.3	Maintenance	18
8.3.1	Cleaning	18
8.3.2	Replacing a Handset	18
8.4	Troubleshooting	18
8.5	Disposal	18



# 1 GENERAL INFORMATION

Documentation for the DMUI-EASY2move Handset consists of this Operating Manual and several other documents (Other applicable documents, page 5). Assembly personnel must read all documentation before starting assembly. Keep all documentation for as long as the product is in your possession. Ensure that all documentation is provided to subsequent owners. Go to [www.logicdata.net](http://www.logicdata.net) for more information and support. This Manual may change without notice. The most recent version is available on our website.

## 1.1 OTHER APPLICABLE DOCUMENTS

This Operating Manual is part of the documentation required to safely assemble and operate the DYNAMIC MOTION SYSTEM (DM System). Other applicable documents include:

- Datasheet for the DMUI-EASY2move Handset
- Datasheet and Operating Manual for the Power Hub in the Table System
- Datasheet and Operating Manual for the Actuator(s) in the Table System
- DYNAMIC MOTION System Manual

## 1.2 COPYRIGHT

© August 2019 by LOGICDATA Electronic und Software Entwicklungs GmbH. All rights reserved, except for those listed in Chapter 1.3 Royalty-free use of images and text on page 5.

## 1.3 ROYALTY-FREE USE OF IMAGES AND TEXT

After purchase and full payment of the product, all text and images in Chapter 2, "Safety", may be used free of charge by the customer for 10 years after delivery. They should be used to prepare end user documentation for height-adjustable table systems. The license does not include logos, designs, and page layout elements belonging to LOGICDATA. The customer may make any necessary changes to the text and images to adapt them for the purpose of end user documentation. No part of the text and no image may be used without the prior written consent of LOGICDATA. Texts and images may not be sold in their current state, and may not be published or sublicensed digitally. The transfer of this license to third parties without permission from LOGICDATA is excluded. Full ownership and copyright of the text and graphics remain with LOGICDATA. Texts and graphics are offered in their current state without warranty or promise of any kind. Contact LOGICDATA to obtain text or images in an editable format ([documentation@logicdata.net](mailto:documentation@logicdata.net)).

## 1.4 TRADEMARKS

Documentation may include the representation of registered trademarks of goods or services, as well as information about copyright or other proprietary expertise of LOGICDATA or third parties. In all cases, all rights remain exclusively with the respective copyright holder. LOGICDATA® is a registered trademark of LOGICDATA Electronic & Software GmbH in the USA, the European Union, and other countries. Unauthorized use or duplication of this or any trademark is strictly prohibited by law.



## 2 SAFETY

### 2.1 TARGET AUDIENCE

This Operating Manual is intended for Skilled Persons only. Refer to Chapter 2.8 Skilled Persons on page 9 to ensure that personnel meet all requirements.

### 2.2 GENERAL SAFETY REGULATIONS

In general, the following safety regulations and obligations apply when handling the product:

- Do not operate the product unless it is in a clean and perfect condition
- Do not remove, change, bridge, or bypass any protection, safety, or monitoring equipment
- Do not convert or modify any components without written approval from LOGICDATA
- In the event of malfunction or damage, faulty components must be replaced immediately
- Unauthorized repairs are prohibited
- Do not attempt to replace hardware unless the product is in a de-energized state
- Only Skilled Persons are allowed to work with DMUI-EASY2move Handsets
- Ensure that national worker protection conditions and national safety and accident prevention regulations are observed during operation of the system

### 2.3 INTENDED USE

The DMUI-EASY2move is a Paddle Switch Handset for electrically Height-Adjustable Tables. It is installed by Resellers into Height-Adjustable Table systems. It is used to control Height-Adjustable Table systems via the DYNAMIC MOTION system. It is intended for indoor use only. It may only be installed in compatible Height-Adjustable Table Systems and with LOGICDATA-approved accessories. Contact LOGICDATA for further details. Use beyond or outside the intended use will void the product's warranty.





### 2.4 REASONABLY FORESEEABLE MISUSE

Usage outside of the intended use may lead to minor injury, serious injury, or even death. Reasonably foreseeable misuse of the Handset includes, but does not extend to:

- Using the Handset as a hook (for coats etc.), a door-/window-stop, or an armrest
- Connecting unauthorized parts to the product. If you are unsure as to whether a part can be used with a Handset, contact LOGICDATA for further information

## 2.5 EXPLANATION OF SYMBOLS AND SIGNAL WORDS

Safety Notices contain both symbols and signal words. The signal word indicates the severity of the hazard.

	<b>DANGER</b>	Indicates a hazardous situation which, if not avoided, will result in death or serious injury.
	<b>WARNING</b>	Indicates a hazardous situation which, if not avoided, could result in death or serious injury.
	<b>CAUTION</b>	Indicates a hazardous situation which, if not avoided, could result in minor or moderate injury.
	<b>NOTICE</b>	Indicates a situation which, if not avoided, could result in damage to the product through electrostatic discharge (ESD).
	<b>NOTICE</b>	Indicates a situation that will not lead to personal injury, but could lead to damage to the device or the environment.
	<b>INFO</b>	Indicates the protection class of a device: Protection Class III. Protection Class III devices may only be connected to SELV or PELV power sources.
	<b>INFO</b>	Indicates important tips for handling the product.

## 2.6 LIABILITY

LOGICDATA products comply with all relevant industry standards, which are listed in the product's data-sheet. However, risk can result from incorrect operation or misuse. LOGICDATA is in particular not liable for damage or injury caused by:

- Improper product use
- Accidental usage
- Clear misuse/abuse of the Table System
- Disregard of the documentation
- Unauthorized product alterations
- Improper work on and with the Table System
- Operation of damaged products
- Normal wear and tear of the Table System or its components
- Wear parts
- Improperly performed repairs
- Unauthorized changes to the operating parameters
- Disasters, external influence, and force majeure

The information in this Operating Manual describes the characteristics of products without assurances. Resellers assume responsibility for the LOGICDATA products installed in their applications. They must ensure their product complies with all relevant directives, standards, and laws. LOGICDATA shall not be held liable for any damage that is directly or indirectly caused by the delivery or use of this document. Resellers must observe the relevant safety standards and guidelines for each product in the Table System.



## 2.7 RESIDUAL RISKS

Residual risks are the risks that remain after all relevant safety standards have been complied with. These have been evaluated in the form of a risk assessment. Residual risks associated with the installation of the DMUI-EASY2move Handset are listed here and throughout this Operating Manual. See also [Chapter 1.1 Other Applicable Documents on page 5](#). The symbols and signal words used in this Operating Manual are listed in [Chapter 2.5 Explanation of Symbols and Signal Words on page 7](#).

- 
- ! WARNING** **Risk of death or serious injury through electric shocks**  
DMUI-EASY2move Handsets are electrical devices. Although you will not have to connect the Handset to the Power Hub during assembly, basic safety precautions must be taken at all times. Failure to observe electrical safety precautions may lead to death or serious injury through electric shocks.
- Never open the Handset
  - Ensure that the Handset is not connected to the Power Hub during assembly
  - Do not convert or modify the Handset in any way
  - Do not immerse the Handset or its components in liquid. Clean only with a dry or slightly damp cloth
  - Do not place the Cable of the Handset on heated surfaces
  - Check the housing and cables of the Handset for visible damage. Do not install or operate damaged products.
- 

- 
- ! WARNING** **Risk of death or serious injury in explosive atmospheres**  
Operating the Handset in potentially explosive atmospheres may lead to death or serious injury through explosions.
- Read the relevant directives to determine if an atmosphere is potentially explosive
  - Do not operate the Handset in potentially explosive atmospheres
- 

- 
- ! WARNING** **Moderate risk of serious injury through electric shocks**  
While cleaning or using the system, liquid intrusion may lead to serious injury through electric shocks.
- Do not allow any components to become wet during cleaning
  - Ensure components are placed away from areas where spillages are likely to occur
  - Take care not to spill liquids onto or around the system
  - If liquid intrusion does occur, replace the Handset immediately.
- 

- 
- ! CAUTION** **Risk of minor or moderate injury through tripping**  
During the assembly process, you may have to step over Cables. Tripping over Cables may lead to minor or moderate injury.
- Ensure that the assembly area is kept clear of unnecessary obstructions
  - Be careful not to trip over Cables
- 

- 
- ! CAUTION** **Risk of minor or moderate injury through crushing**  
If excessive force is applied to the DMUI-EASY2move, the Table System may become damaged. The use of damaged products may lead to minor or moderate injury through crushing.
- Do not apply excessive force to the Handset
-





## 2.8 SKILLED PERSONS



### CAUTION

#### **Risk of injury through incorrect assembly**

Only Skilled Persons have the expertise to complete the assembly process safely. Assembly by Unskilled Persons may lead to minor or moderate injury.

- Ensure that only Skilled Persons are allowed to complete assembly
- Ensure that persons with limited ability to react to danger do not take part in the assembly process

DMUI-EASY2move Handsets may only be installed by Skilled Persons. A Skilled Person is defined as someone who:

- Is authorized for installation planning, installation, commissioning, or servicing of the product
- Has read and understood all documentation relevant to the Handset
- Has the technical education, training, and/or experience to perceive risks and avoid hazards
- Has knowledge of the specialist standards applicable to the product
- Has the expertise to test, assess, and manage electrical and mechatronic products and systems in accordance with the generally accepted standards and guidelines of electrical engineering and furniture manufacturing

## 2.9 NOTES FOR RESELLERS

Resellers are companies that purchase LOGICDATA products for installation in their own products.

INFO	For reasons of EU conformity and product safety, Resellers should provide end users with an Operating Manual in their native EU official language.
INFO	<p>The Charter of the French Language (<b>La charte de la langue française</b>) or Bill 101 (<b>Loi 101</b>) guarantees the right of the population of Quebec to conduct business and commercial activities in French. The bill applies to all products sold and used in Quebec. For table systems that will be sold or used in Quebec, Resellers must provide all product-relevant texts in French. These include, but are not limited to:</p> <ul style="list-style-type: none"><li>• Operating Manuals</li><li>• All other product documentation, including datasheets</li><li>• Inscriptions on the product (such as labels), including those on product packaging</li><li>• Warranty certificates</li></ul> <p>The French inscription may be accompanied with a translation or translations, but no inscription in another language may be given greater prominence than that in French.</p>
INFO	Operating Manuals must include all the safety instructions that end users require to handle the product safely. They must also include an instruction to always keep the Operating Manual in the immediate vicinity of the product.
INFO	No unauthorized persons (young children, persons under the influence of medications, etc.) should be allowed to handle the product.
INFO	Resellers must perform a risk assessment on their product that covers residual hazards. It must include measures to mitigate risk, or reference the product's Operating Manual.

## 3 SCOPE OF DELIVERY

The standard scope of delivery for the DMUI-EASY2move Handset consists of the Handset and its pre-attached cable. All other components necessary for installing the Handset must be supplied separately by the reseller.



## 4 UNPACKAGING



### NOTICE

Ensure proper ESD handling during unpackaging. Damage that can be attributed to electrostatic discharge will void warranty claims.

To unpackage the product:

1. Remove all components from the packaging
2. Check the contents of the package for completeness and damage
3. Provide the Operating Manual to the operating personnel
4. Dispose of the packaging material

### NOTICE

Dispose of the packaging material in an environmentally friendly manner. Remember to separate plastic parts from the cardboard packaging.

## 5 PRODUCT

The illustrations in this chapter show a standard model of the DMUI-EASY2move Handset. The exact variant of the DMUI-EASY2move is denoted by the product's order code. Consult the accompanying data sheet to ensure that you have received the correct variant.

### 5.1 KEY PRODUCT FEATURES

1	LEDs
2	Mounting Points
3	Save Button

\*Cable not shown.

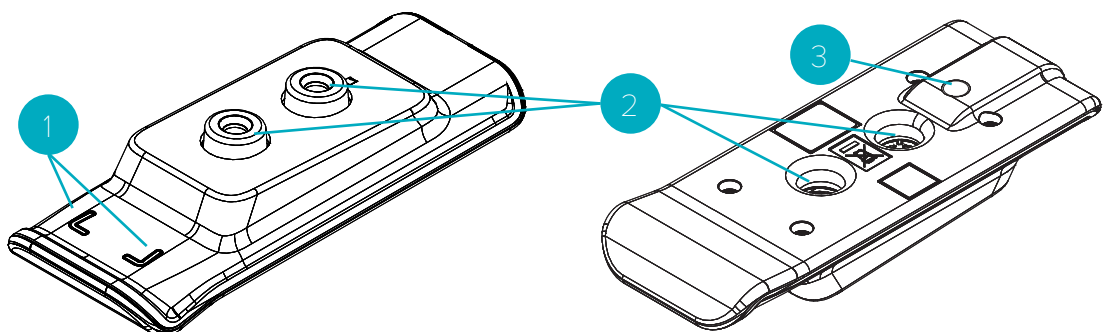

**Fig. 1:** Product features, DMUI-EASY2move (top view left, bottom view right)



## 5.2 DIMENSIONS

Length	121.82 mm   4.796 "
Width	47.22 mm   1.859 "
Height (Contact Point to Mounting Point)	25.85 mm   1.136 "

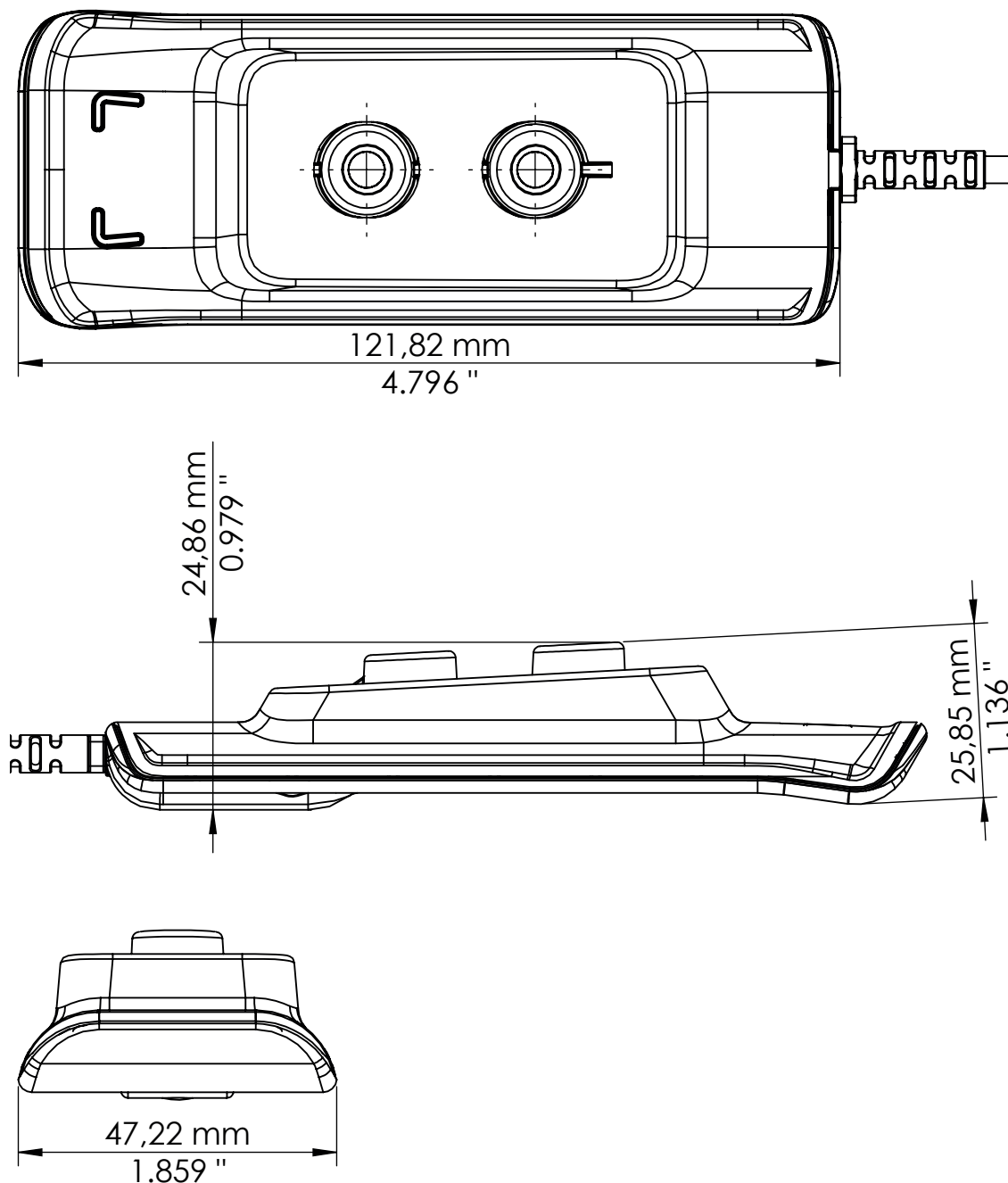

Fig. 2: Product dimensions, DMUI-EASY2move



### 5.3 DRILLING TEMPLATE

The Drilling Template below is a recommended Mounting Position. Resellers are allowed to choose any suitable position for the DMUI-EASY2move. In the recommended Mounting Position, the DMUI-EASY2move is positioned so that the distance from the front edge of the table to the centre of the first Mounting Point is 40 mm. The Handset should not protrude from the side of the Table. The distance between the centres of the mounting points (diameter 5.3 mm) is 25 mm.

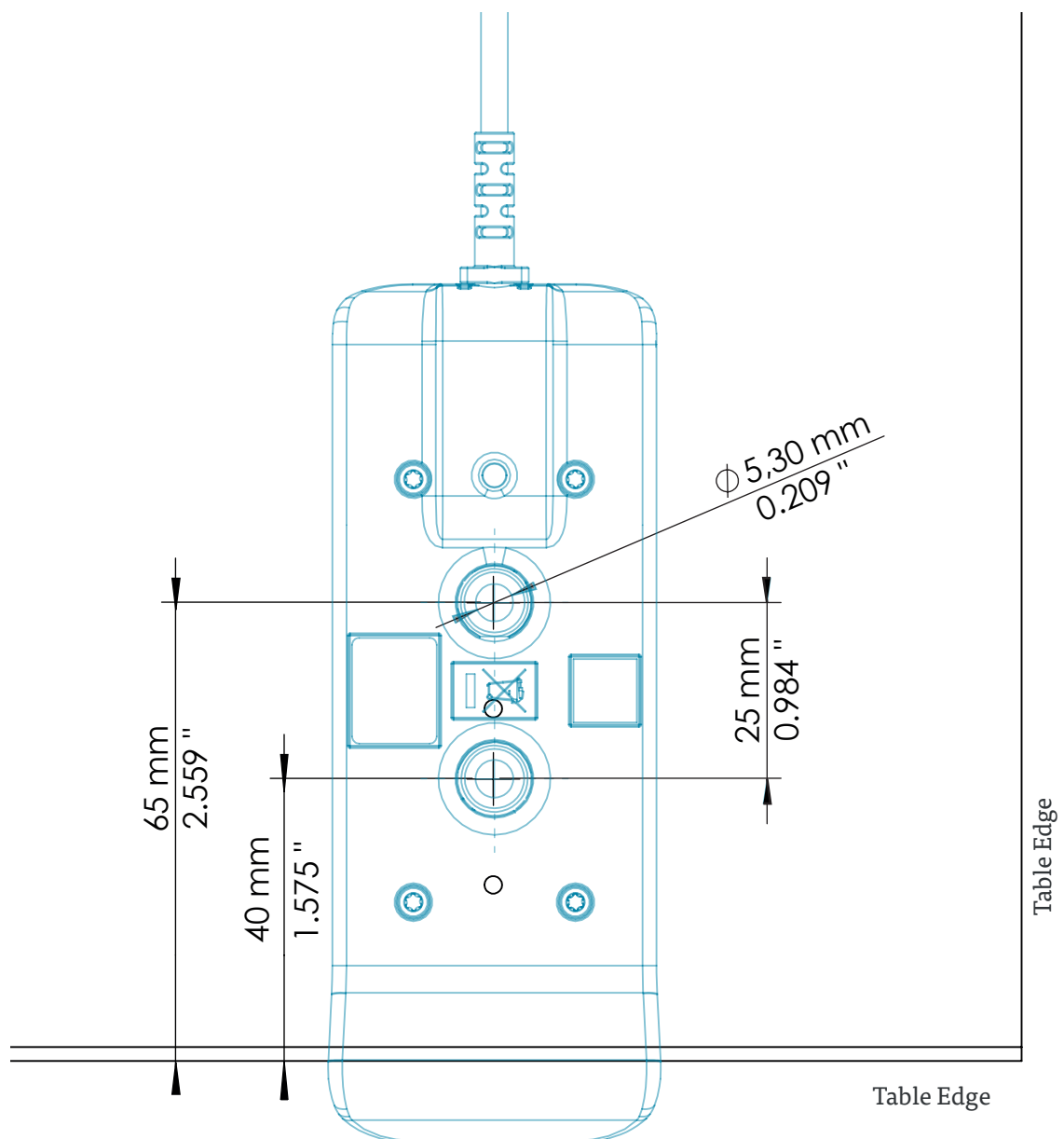

Fig. 3: Drilling Template, DMUI-EASY2move



## 6 ASSEMBLY

This chapter describes the process of installing the DMUI-EASY2move into the Height-Adjustable Table System.

### 6.1 SAFETY DURING ASSEMBLY



- CAUTION** **Risk of minor or moderate injury through improper handling**  
Improper handling of the product during assembly may lead to minor or moderate injury through cutting, pinching, and crushing.
- Avoid contact with sharp edges
  - Be careful while handling tools that may cause personal injury
  - Ensure assembly complies with the generally accepted standards and guidelines of electrical engineering and furniture manufacturing
  - Read all instructions and safety advice carefully

- CAUTION** **Risk of minor or moderate injury through tripping**  
During assembly and operation, poorly routed Cables may become a trip hazard. Tripping over Cables may lead to minor or moderate injury.
- Ensure that Cables are routed properly to avoid trip hazards
  - Be careful not to trip over Cables when installing the Handset

- NOTICE** Ensure proper ESD handling during assembly. Damage that can be attributed to electrostatic discharge will void warranty claims.

- NOTICE** To avoid damage to the product during assembly, ensure:
- You have measured the dimensions of the product before assembly.
  - All parts are acclimatised to the ambient conditions.
  - You do not lift the Handset by its cable

- INFO** Perform a product risk assessment so that you can respond to potential residual hazards. Assembly instructions must be included in your end user Operating Manual.

### 6.2 REQUIRED COMPONENTS

1	DMUI-EASY2move
2	2 Mounting Screws (supplied by Reseller)
Tool	Drill or Drilling Machine
Tool	Screwdriver

- INFO** **Screw specifications**  
The Mounting Points for the DMUI-EASY2move have a diameter of 5.3 mm. The Mounting Screws must be long enough to pass through the housing and should hold the Handset safely and securely in place. Exact specifications can be provided by LOGICDATA on request.

### 6.3 PROCESS

1. Position the Handset under the table top and mark the position of the mounting points or use the Drilling Template on page 12 to help you.
2. Drill the holes into the Table Top.
3. Use the screwdriver and Mounting Screws to attach the Handset to the Table Top at the drilled holes.

- NOTICE** Tightening torque depends on the material of the Table Top. Do not exceed 2 Nm.

### 6.4 COMPLETING ASSEMBLY

After the DMUI-EASY2move is attached to the Table Top, you must connect the Cable to the DYNAMIC MOTION system. Refer to the DYNAMIC MOTION system manual for instructions.



## 7 OPERATION

- 
- ! CAUTION** **Risk of minor or moderate injury through uncontrolled movement**  
The table may not always stop exactly at the expected position. Failure to anticipate the table's movements may lead to minor or moderate injury through crushing.
- Wait until the system has completely stopped before attempting to use the table
- 
- ! CAUTION** **Risk of minor or moderate injury through unsecured objects**  
While the table moves up and down, unsecured objects may fall off the table and onto body parts. This may lead to minor or moderate injury through crushing.
- Ensure loose objects are kept away from the edge of the table
  - Do not leave unnecessary objects on the table during movement
- 
- ! CAUTION** **Risk of minor or moderate injury through crushing**  
Attempting to use the Table System before it is properly mounted and connected may result in malfunctions. These may lead to minor or moderate injury through crushing.
- Ensure all Components have been mounted safely
  - Ensure all Cables are properly connected
  - Ensure that all required Actuators are ready to be operated
  - Do not operate the Table System until it is properly connected
- 

Instructions for operating the system can be found in the DYNAMIC MOTION System Manual. A list of core features can be found below. Before using the Table System, you must also read the Operating Manuals of all components, as well as the DYNAMIC MOTION system manual, including all relevant safety information, in full.

### 7.1 ADJUSTING THE TABLE TOP HEIGHT

- 
- ! CAUTION** **Risk of minor or moderate injury through crushing**  
Your fingers may be crushed when you attempt to change the height of the table
- Keep fingers away from moving parts
  - Ensure that no persons or objects are in the table's range of motion
- 
- INFO** The Table Top will move up or down until the paddle is released, or if a pre-defined stopping point has been reached.
- 
- INFO** The LEDs on the DMUI-EASY2move will light up white when the table is in motion.
- 

#### 7.1.1 MOVING THE TABLE TOP UP

Gently lift and hold the paddle until the desired height has been reached (Fig. 4).

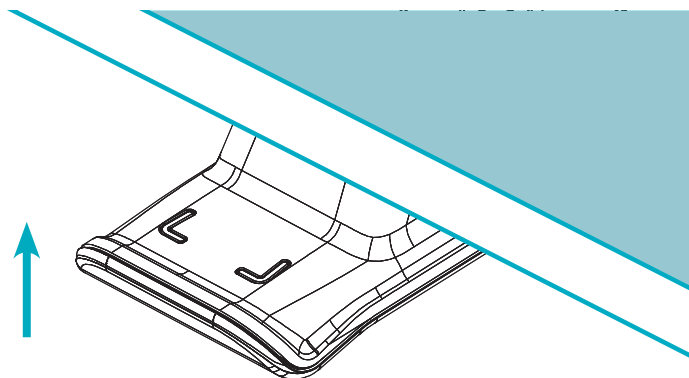
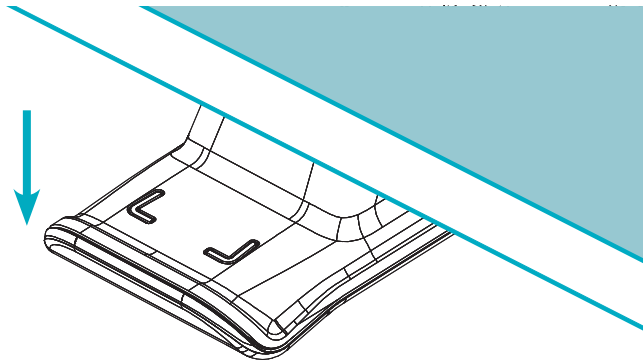

**Fig. 4:** Moving the Table Top Up



## 7.1.2 MOVING THE TABLE TOP DOWN

Gently push and hold down the paddle until the desired height has been reached (Fig. 5).



**Fig. 5:** Moving the Table Top Down

## 7.2 CONTAINER STOP AND SHELF STOP POSITIONS

These features can limit the movement area of the Table Top (if e.g. a container is below the table or a shelf is above it). Container Stop Positions become the new lowest end position, Shelf Stop Positions the highest.

### INFO

Container Stop Positions can only be saved only in the lower half of the movement area, Shelf Stop Positions in the upper half. You must set each position separately.

### 7.2.1 SAVE A CONTAINER STOP OR SHELF STOP POSITION

1. Use the Paddle to move the Table Top to the desired height.
2. Press and hold the **SAVE Key** for 10 seconds.
  - ▶ The Container Stop / Shelf Stop Position is saved (Container Stop if you are in the bottom half of the movement area, Shelf Stop if you are in the top half).

### 7.2.2 DELETE A CONTAINER STOP OR SHELF STOP POSITION

1. Use the Paddle to move the Table Top to the position you wish to delete.
2. Press and hold the **SAVE Key** for 10 seconds.
  - ▶ The Container Stop / Shelf Stop Position is deleted (Container Stop if you are in the bottom half of the movement area, Shelf Stop if you are in the top half).

## 7.3 PERFORMING A POSITION RESET PROCEDURE



### CAUTION

#### **Risk of minor or moderate injury through crushing**

Collision Detection (ISP) is inactive during start-up and reset processes. This may lead to minor or moderate injury through crushing.

- Ensure that no persons or objects are in the table's range of motion

The Position Reset Procedure is used to align the position of the Actuators within the Table System. It is required before first use of the Table System.



1. Gently push and hold down the paddle until the table stops at the lower position limit
2. Release the Paddle
3. Push and hold down the Paddle again
  - ▶ The table will move down slightly, then up again
4. Release the Paddle
  - ▶ The Position Reset Procedure is complete.

**INFO**

If your DYNAMIC MOTION system has been parameterized with additional stopping points (e.g. a Container Stop Position), repeat Step 3 until the table has moved upwards again.

## 7.4 FACTORY RESET (SO RESET)

With this function, you can reset the DYNAMIC MOTION system to its factory settings.

1. Press the **SAVE Key** once, then release
2. Press and hold the **SAVE Key** for 10 seconds
  - ▶ The LED will light up Red
3. When the LED light begins to blink, release the **SAVE Key**

The DYNAMIC MOTION system has now been reset to its factory settings. It is now in the same state as it was during the first start-up.





## 8 SYSTEM INFORMATION

When a DMUI-EASY2move Handset is installed alongside the DYNAMIC MOTION system, system information is communicated via flashes of the LED Signal Light. Possible signals are as follows:

Signal	Message	Required Actions
No Light	System operating normally	Operate the DM System as normal.
	System not connected properly	See the DM System Manual for connection instructions.
White Light On	System is in Motion	The system is moving. Keep away from moving parts and ensure the table is in full vision.
Red Light Blinking	System Error Warning	<p>Release all Keys and wait for 5 seconds. Then, try to repeat the action again.</p> <p>Disconnect the DM System from the Power Unit.</p> <p>(If a Power Hub is used) Disconnect the Power Hub from the Mains.</p> <p>Check the Power Unit for overheating. Let cool if necessary.</p> <p>Check all cable connections and reconnect the system.</p> <p><b>If problem persists:</b></p> <p>Perform a Position Reset Procedure (see System Manual).</p> <p>Contact LOGICDATA</p>
Green Light Blinking	System Start-up	Wait until the LED has stopped blinking to continue. Do not press any buttons.
	Reset in Progress	
	Duty Cycle Exceeded	
	Collision Detected (ISP)	Remove the obstruction from the Table System. Remove unnecessary loads from the Table Top Operate the DM System as normal.

**NOTICE** Do not operate the DYNAMIC MOTION system if problems persist. Contact LOGICDATA for further information.



## 9 ADDITIONAL INFORMATION

### 9.1 SOFTWARE-DEPENDENT FUNCTIONS

A full list of Software-Dependent Functions can be found in the DYNAMIC MOTION system manual.

### 9.2 DISASSEMBLY

To disassemble the DMUI-EASY2move, disconnect the DYNAMIC MOTION system from the mains. Then, follow the assembly instructions in reverse order.

### 9.3 MAINTENANCE

The DMUI-EASY2move Handset is maintenance-free.



#### **! WARNING**

#### **Risk of death or serious injury through electric shocks and other hazards**

Using a Handset alongside unauthorized spare or accessory parts may lead to death or serious injury through electric shocks and other hazards.

- Only use accessory parts produced or approved by LOGICDATA
- Only use replacement parts produced or approved by LOGICDATA
- Only allow Skilled Persons to perform repairs or install accessory parts
- Contact customer services immediately if the system malfunctions

The use of unauthorized spare or accessory parts may cause system damage. Warranty claims are void in this scenario.

#### 9.3.1 CLEANING

1. Disconnect the DYNAMIC MOTION system from the mains.
2. Wait 30 seconds for residual voltage to dissipate.
3. Wipe the Handset with a dry or slightly damp soft cloth. Never immerse the Handset in liquid.
4. Wait for the Handset to dry completely.
5. Reconnect the DYNAMIC MOTION system

#### 9.3.2 REPLACING A HANDSET

1. Disconnect the DYNAMIC MOTION system from the Mains.
2. Disconnect the Handset from the Power Hub.
3. Remove the Handset from the Table Top.
4. Mount the new Handset onto the Table Top.
5. Plug the Handset back into the Power Hub.
6. Reconnect the DYNAMIC MOTION system to the Mains.

### 9.4 TROUBLESHOOTING

Usually, malfunctions occur when Handsets are pressed while calibrating. If the Handset fails to function, you will need to restart the system. To do this:

1. Unplug the Handset from the Power Hub.
2. Plug the Handset back into Power Hub.
3. After a few seconds the Handset is ready for operation.

A list of common problems and their solutions can be found in the DYNAMIC MOTION system manual.

### 9.5 DISPOSAL



All products in the DM System are subject to the WEEE Directive 2012/19/EU.

- Dispose of all components separately from household waste. Use designated collection points or disposal companies authorized for this purpose



# MOTION FOR YOUR LIFE

**LOGICDATA**  
**Electronic & Software Entwicklungs GmbH**  
Wirtschaftspark 18  
8530 Deutschlandsberg  
Austria

Phone: +43 (0)3462 5198 0  
Fax: +43 (0)3462 5198 1030  
Email: [office.at@logicdata.net](mailto:office.at@logicdata.net)  
Internet: <http://www.logicdata.net>

**LOGICDATA North America, Inc.**  
Broadmoor Ave SE, Suite D  
Grand Rapids MI  
USA

Phone: +1 (616) 328 8841  
Email: [office.na@logicdata.net](mailto:office.na@logicdata.net)



[www.logicdata.net](http://www.logicdata.net)